

## Scallop Pocket Card Template

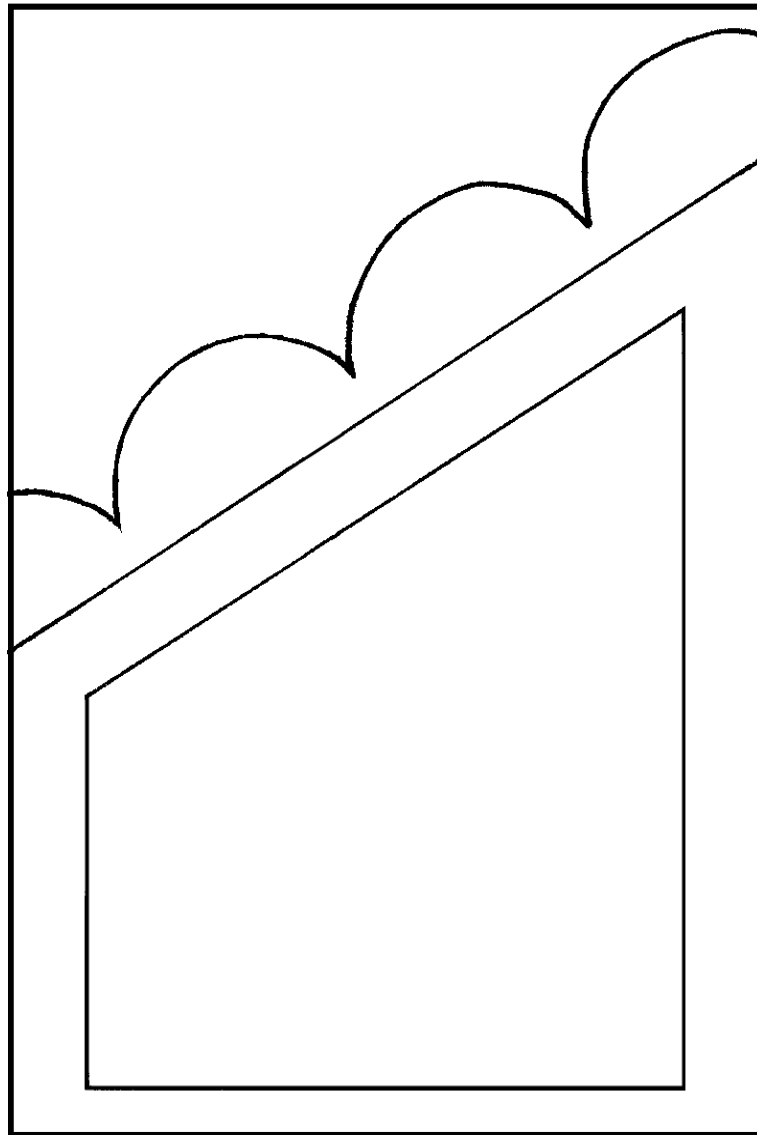

www.craftytemplates.co.uk  
© L Banks 2008

You can use this template any way around you choose to. The outermost line is the size of a standard A6 card blank. Cut along the straight edge and/or the scallop edge to create a pocket on the front of your card to which you can add an additional element such as a tag etc.

## Scallop Pocket Card Template

This template you can play around with and create different cards. In the sample card bellow I used the scallop edge to make my pocket with, adhering it around the edges and leaving the scalloped edge open then just popping a decorated tag inside.

You can also use the straight edge (the line under the scalloped line) to make a card in a similar way or use the inner pocket lines to make a smaller pocket.

You can also turn the template upside down and use the shapes in a layered decorative way, popping a message in the bottom right corner.

Have fun!



This project is for adult use only as it involves using cutting tools and using materials that may ruin clothing. Crafty Templates or anyone associated or manufacturers mentioned in the instructions can not be held responsible for any damage to personal clothing or property that may arise from the use of these projects and templates. Please read the full terms and conditions of use, which you can find on [www.craftytemplates.co.uk](http://www.craftytemplates.co.uk). You can also find contact details here if you need any further help with your templates or ideas for your cards.

# Spinner Card Templates

Fits a C6 card (landscape)

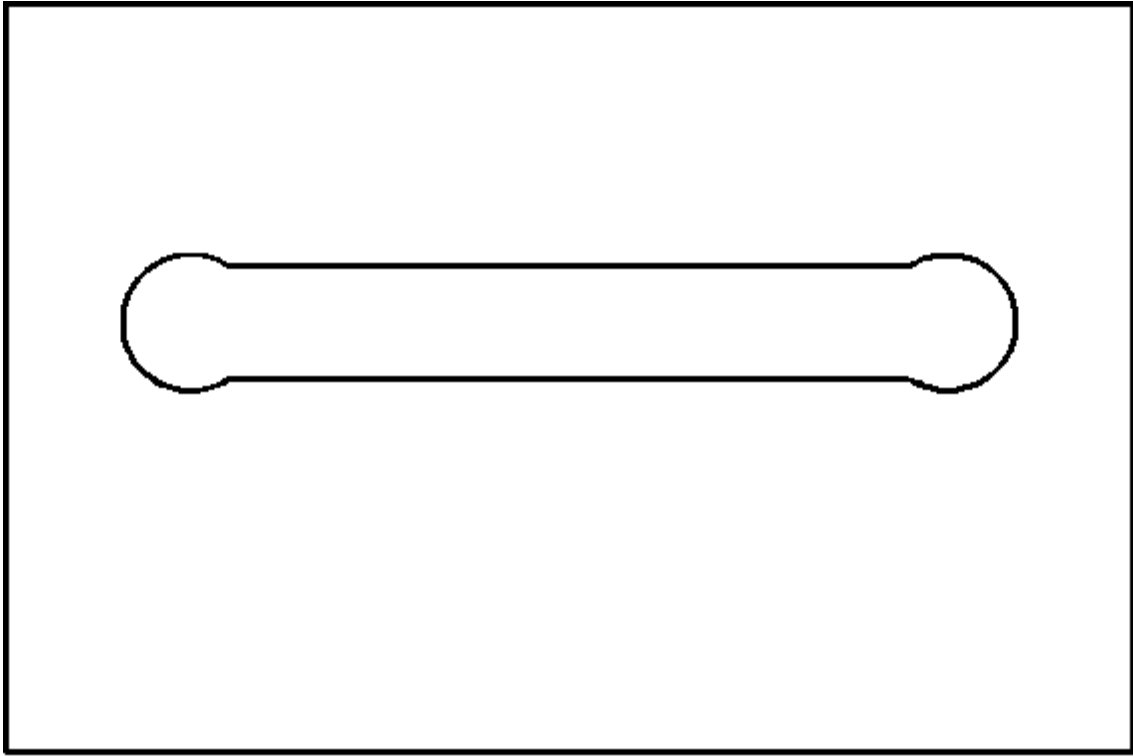

Fits a large square card (14x14)

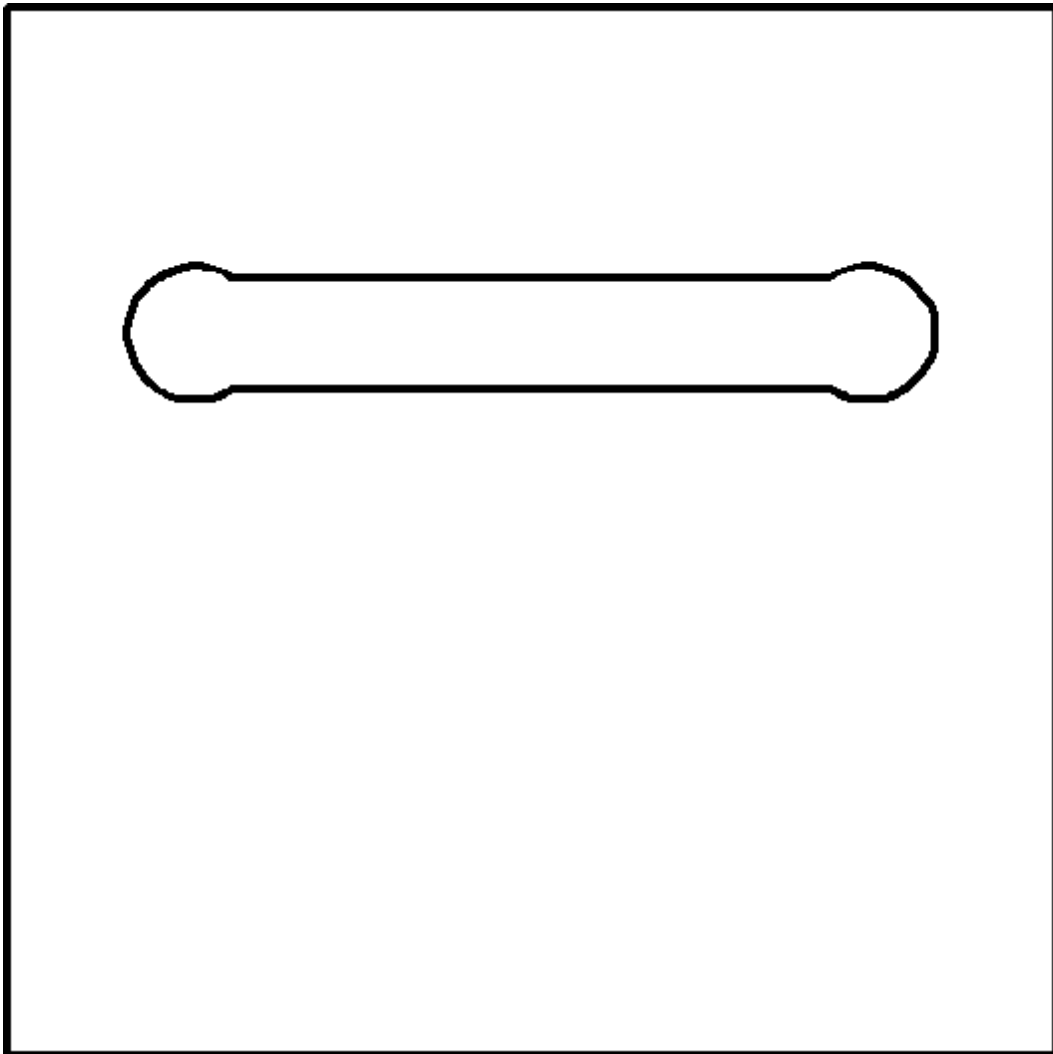

## Spinner Card Templates

I know these aren't new but they are fun and they're perfect to use along with your Embellish Buddies templates. Don't get scared, using the template sheet I've made up makes them mega easy to make!

### Instructions

First print off the template sheet on to a piece of A4 card. Decide which size slider card you would like to make and cut out the corresponding size template from the sheet, cutting around the outside and cutting out the centre piece from the middle (as if you were cutting an aperture from your card). Cover the whole of the front of the piece of card with some patterned paper or alternatively you can decorate the front of your card with stamps or other embellishments. If you cover your card make sure you re-cut out the aperture too. Next you need to choose a little picture to make your spinner topper for your card. I chose the 'Pup' Embellish Buddie picture and resized him so he was about 5cm across then printed him on to some brown coloured card and cut him out. You can add colour at this stage with pens/pencils or alternatively print or stamp a shape/picture on to patterned paper. When you've finished your spinner topper pop it to one side. Now comes the magic bit. You'll need two pennies and some 3D foam pads or if you haven't got 3D foam pads use a small square of corrugated card along with doublesided tape. Make a 'sandwich' with a penny then 3D foam (keep it to the centre of the penny) and then the other penny (so the foam is in-between the pennies). Use more 3D foam pads to stick your spinner topper on top of your penny sandwich. Next take your front piece of card and wiggle the penny inside the aperture bit so the card sits in to the middle of the two pennies and can slide from one side to the other. At this stage if you want to cover your card blank you can do but it will only show through the slider aperture bit. Finally use more foam pads (or corrugated card again) to stick your slider card onto the front of your card blank.

Have fun!



This project is for adult use only as it involves using cutting tools and using materials that may ruin clothing. Crafty Templates or anyone associated or manufacturers mentioned in the instructions can not be held responsible for any damage to personal clothing or property that may arise from the use of these projects and templates. Please read the full terms and conditions of use, which you can find on [www.craftytemplates.co.uk](http://www.craftytemplates.co.uk). You can also find contact details here if you need any further help with your templates or ideas for your cards.

## A6 Rocking Card Template

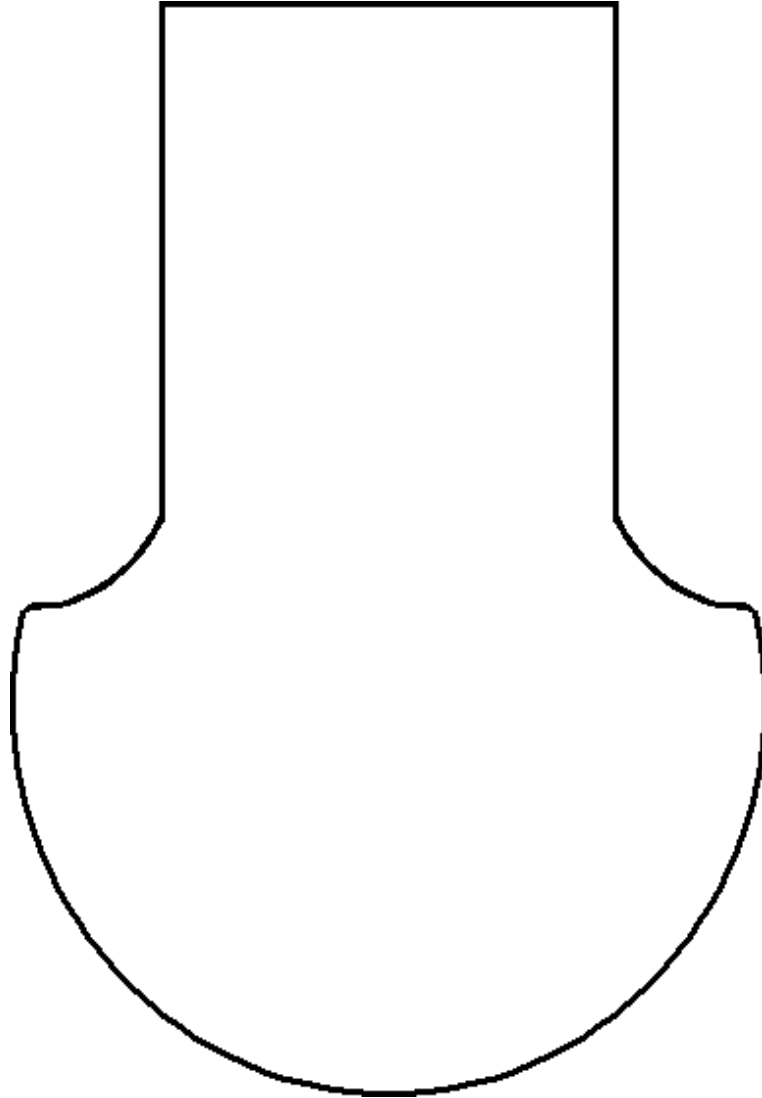

Large Square Rocking Card Template

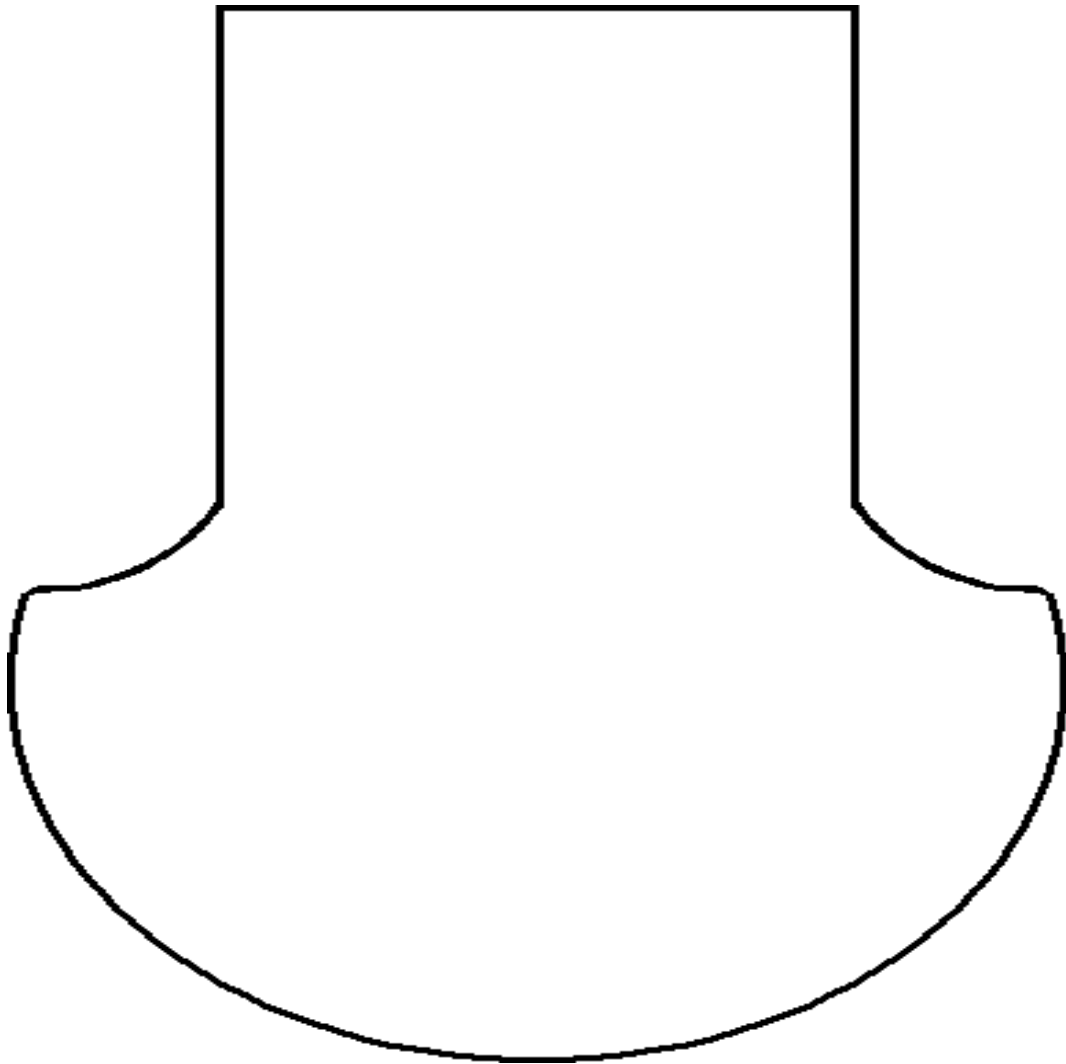

## Rocking Card Template

First choose which size of card you would like to make and print off the corresponding template sheet. Cut out the shape. Fold a piece of A4 card in half and place the card template on the card matching the top straight edge up to the fold on the card.

Draw around the shape and then cut it out keeping the card folded. Now you have your base card done. To make your card 'rock' successfully it needs a counter weight. The thing I found that works the best is a penny. Your penny needs to go at the bottom of your card (about 5mm away from the edge) and in the centre so take this into account when choosing an embellishment to use on your card. I used the

Christmas Tree with pot Embellish Buddie picture printed the size it comes (it's sized already to fit a A6 size card so there shouldn't be any need for you to resize it for an A6 size card). The pot just covers the penny at the bottom perfectly. Otherwise you could choose a group of embellishments and have just one of them covering over the penny. Layer your embellishment on top of the card with foam pads so it hides the penny.

Have fun!



This project is for adult use only as it involves using cutting tools and using materials that may ruin clothing. Crafty Templates or anyone associated or manufacturers mentioned in the instructions can not be held responsible for any damage to personal clothing or property that may arise from the use of these projects and templates. Please read the full terms and conditions of use, which you can find on [www.craftytemplates.co.uk](http://www.craftytemplates.co.uk). You can also find contact details here if you need any further help with your templates or ideas for your cards.